

REAL ESTATE WEEKLY

November 10, 2004

Gross completes midtown 'green' dream

Amie Gross Architects (AGA) announced the completion of a new treatment center for the nationally renowned Duke Chiropractic at 9 East 38th Street. The 4,000 square-foot space was created using "green" materials.

The office incorporates materials with improved environmental and health characteristics in all areas of the space including bamboo flooring, low VOC paints and wood products, along with Panelite, a fiberglass/aluminum composite.

Translucent panels in varied colors and textures decorate the office. The center includes exam, massage and treatment rooms, an exercise studio, offices and a waiting area containing a retail section. "Our design trans-

formed a narrow setting with minimal natural light into an uplifting environment of open space and brightness," states AGA principal and founder Amie Gross (AIA), "and the combination of warm colors and materials with the crispness of plastic and metal cre-

ates a compelling contrast."

Adds Duke Chiropractic owner Dr. Scott Duke: "The use of green materials fits in with our holistic view of treatment, and combined with a purifying fountain promotes an overall sense of well being."

Duke Chiropractic was established in 1992. The group provides chiropractic services, manual therapy and massage for its clients, with a specialization in sports injuries, spinal rehabilitation, post surgical rehabilitation and nutrition.

AGA is a nationally recognized Manhattan-based firm specializing in the design of new buildings including family housing and community facilities. In addition, the company has considerable expertise in the design of interior spaces including offices and retail stores.

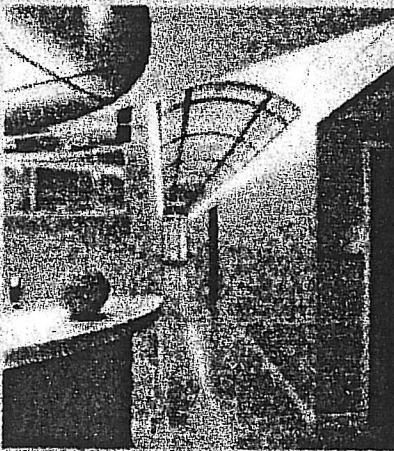

The 4,000 s/f space was created using "green" materials.